

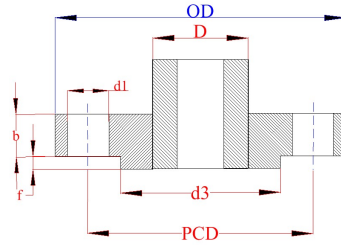

**ENERGY
METALS**



ENERGY
ENGINEERED PRODUCTS

DISTRIBUTORS OF INDUSTRIAL STAINLESS STEEL PRODUCTS: PIPE, FITTINGS, FLANGES, ROUND BAR, VALVES

FLANGE TABLES

15 mm Nominal Bore (1/2") - Pipe OD 21.3mm

Standard	Class/ Table	Flange OD	Flange Thickness (B)	Raised Face Dia. (d3)	Raised Face Height	No. Holes	Hole Dia (d1)	Bolt Size	PCD	Mass Kg
BS 4504	6/3	80.0	12.0	40.0	2.0	4	11.0	M10	55.0	0.4
	10/3	95.0	14.0	45.0	2.0	4	14.0	M12	65.0	0.6
	16/3	95.0	14.0	45.0	2.0	4	14.0	M12	65.0	0.6
	25/3	95.0	16.0	45.0	2.0	4	14.0	M12	65.0	0.7
	40/3	95.0	16.0	45.0	2.0	4	14.0	M12	65.0	0.7
SABS 1123	600/3	80.0	10.0	40.0	2.0	4	11.0	M10	55.0	0.3
	1000/3	95.0	10.0	45.0	2.0	4	14.0	M12	65.0	0.4
	1600/3	95.0	10.0	45.0	2.0	4	14.0	M12	65.0	0.4
	2500/3	95.0	14.0	45.0	2.0	4	14.0	M12	65.0	0.6
	4000/3	95.0	14.0	45.0	2.0	4	14.0	M12	65.0	0.6
BS 10	D	95.3	4.8			4	14.3	12.7	66.7	0.7
	E	95.3	6.3			4	14.3	12.7	66.7	0.7
	F	95.3	9.5			4	14.3	12.7	66.7	0.7
ASME B16.5	150	88.9	11.1	34.9	1.6	4	15.9	1/2"	60.3	0.3
	300	95.2	14.3	34.9	1.6	4	15.9	1/2"	66.7	0.6
	600	95.2	20.6	34.9	6.4	4	15.9	1/2"	34.9	

40 mm Nominal Bore (1 1/2") - Pipe OD 48.3mm

Standard	Class/ Table	Flange OD	Flange Thickness (B)	Raised Face Dia. (d3)	Raised Face Height	No. Holes	Hole Dia (d1)	Bolt Size	PCD	Mass Kg
BS 4504	6/3	130.0	16.0	80.0	3.0	4	14.0	M12	100.0	1.2
	10/3	150.0	16.0	88.0	3.0	4	18.0	M16	110.0	1.6
	16/3	150.0	16.0	88.0	3.0	4	18.0	M16	110.0	1.6
	25/3	150.0	20.0	88.0	3.0	4	18.0	M16	110.0	2.1
	40/3	150.0	20.0	88.0	3.0	4	18.0	M16	110.0	2.1
SABS 1123	600/3	130.0	10.0	80.0	3.0	4	14.0	M12	100.0	0.8
	1000/3	150.0	10.0	88.0	3.0	4	18.0	M16	110.0	1.0
	1600/3	150.0	10.0	88.0	3.0	4	18.0	M16	110.0	1.0
	2500/3	150.0	20.0	88.0	3.0	4	18.0	M16	110.0	2.1
	4000/3	150.0	20.0	88.0	3.0	4	18.0	M16	110.0	2.1
BS 10	D	6.3	6.3			4	14.2	12.7	98.4	1.2
	E	8.7	8.7			4	14.2	12.7	98.4	1.2
	F	12.7	12.7			4	17.5	15.9	104.8	1.3
ASME B16.5	150	127.0	17.5	73.0	1.6	4	15.9	1/2"	98.4	1.3
	300	155.6	20.6	73.0	1.6	4	22.2	3/4"	114.3	2.5
	600	155.6	28.5	73.0	6.4	4	22.2	3/4"	114.3	

20 mm Nominal Bore (3/4") - Pipe OD 26.9mm

Standard	Class/ Table	Flange OD	Flange Thickness (B)	Raised Face Dia. (d3)	Raised Face Height	No. Holes	Hole Dia (d1)	Bolt Size	PCD	Mass Kg
BS 4504	6/3	90.0	14.0	50.0	2.0	4	11.0	M10	65.0	0.5
	10/3	105.0	16.0	58.0	2.0	4	14.0	M12	75.0	0.9
	16/3	105.0	16.0	58.0	2.0	4	14.0	M12	75.0	0.9
	25/3	105.0	18.0	58.0	2.0	4	14.0	M12	75.0	1.0
	40/3	105.0	18.0	58.0	2.0	4	14.0	M12	75.0	1.0
SABS 1123	600/3	90.0	10.0	50.0	2.0	4	11.0	M10	65.0	0.4
	1000/3	105.0	10.0	58.0	2.0	4	14.0	M12	75.0	0.5
	1600/3	105.0	10.0	58.0	2.0	4	14.0	M12	75.0	0.5
	2500/3	105.0	14.0	58.0	2.0	4	14.0	M12	75.0	0.8
	4000/3	105.0	14.0	58.0	2.0	4	14.0	M12	75.0	0.8
BS 10	D	101.6	4.8			4	14.2	12.7	73.0	0.8
	E	101.6	6.3			4	14.2	12.7	73.0	0.8
	F	101.6	9.5			4	14.2	12.7	73.0	0.8
ASME B16.5	150	98.4	12.7	42.9	1.6	4	15.9	1/2"	69.8	0.6
	300	117.5	15.9	42.9	1.6	4	19.1	5/8"	82.5	1.1
	600	117.5	22.2	42.9	6.4	4	19.1	5/8"	82.5	

50 mm Nominal Bore (2") - Pipe OD 60.3mm

Standard	Class/ Table	Flange OD	Flange Thickness (B)	Raised Face Dia. (d3)	Raised Face Height	No. Holes	Hole Dia (d1)	Bolt Size	PCD	Mass Kg
BS 4504	6/3	140.0	16.0	90.0	3.0	4	14.0	M12	110.0	1.3
	10/3	165.0	18.0	102.0	3.0	4	18.0	M16	125.0	2.2
	16/3	165.0	18.0	102.0	3.0	4	18.0	M16	125.0	2.2
	25/3	165.0	20.0	102.0	3.0	4	18.0	M16	125.0	2.5
	40/3	165.0	20.0	102.0	3.0	4	18.0	M16	125.0	2.5
SABS 1123	600/3	140.0	10.0	90.0	3.0	4	14.0	M12	110.0	0.8
	1000/3	165.0	10.0	102.0	3.0	4	18.0	M16	125.0	1.2
	1600/3	165.0	12.0	102.0	3.0	4	18.0	M16	125.0	1.5
	2500/3	165.0	20.0	102.0	3.0	4	18.0	M16	125.0	2.5
	4000/3	165.0	20.0	102.0	3.0	4	18.0	M16	125.0	2.5
BS 10	D	152.4	7.9			4	17.5	15.9	114.3	1.5
	E	152.4	9.5			4	17.5	15.9	114.3	1.5
	F	165.1	15.9			4	17.5	15.9	127.0	2.2
ASME B16.5	150	152.4	19.1	92.1	1.6	4	19.1	5/8"	120.6	2.1
	300	165.1	22.2	92.1	1.6	8	19.1	5/8"	127.0	2.9
	600	165.1	31.7	92.1	6.4	8	19.1	5/8"	127.0	

25 mm Nominal Bore (1") - Pipe OD 33.7mm

Standard	Class/ Table	Flange OD	Flange Thickness (B)	Raised Face Dia. (d3)	Raised Face Height	No. Holes	Hole Dia (d1)	Bolt Size	PCD	Mass Kg
BS 4504	6/3	100.0	14.0	60.0	2.0	4	11.0	M10	75.0	0.7
	10/3	115.0	16.0	68.0	2.0	4	14.0	M12	85.0	1.0
	16/3	115.0	16.0	68.0	2.0	4	14.0	M12	85.0	1.0
	25/3	115.0	18.0	68.0	2.0	4	14.0	M12	85.0	1.2
	40/3	115.0	18.0	68.0	2.0	4	14.0	M12	85.0	1.2
SABS 1123	600/3	100.0	10.0	60.0	2.0	4	11.0	M10	75.0	0.5
	1000/3	115.0	10.0	68.0	2.0	4	14.0	M12	85.0	0.6
	1600/3	115.0	10.0	68.0	2.0	4	14.0	M12	85.0	0.6
	2500/3	115.0	16.0	68.0	2.0	4	14.0	M12	85.0	1.1
	4000/3	115.0	16.0	68.0	2.0	4	14.0	M12	85.0	1.1
BS 10	D	114.3	4.8			4	12.7	12.7	82.6	1.0
	E	114.3	7.1			4	12.7	12.7	82.6	0.9
	F	120.3	9.5			4	15.9	15.9	87.3	1.0
ASME B16.5	150	107.9	14.3	50.8	1.6	4	15.9	1/2"	79.4	0.8
	300	123.8	17.5	50.8	1.6	4	19.1	5/8"	88.9	1.4
	600	123.8	23.8	50.8	6.4	4	19.1	5/8"	88.9	

65 mm Nominal Bore (2 1/2") - Pipe OD 76.1mm

Standard	Class/ Table	Flange OD	Flange Thickness (B)	Raised Face Dia. (d3)	Raised Face Height	No. Holes	Hole Dia (d1)	Bolt Size	PCD	Mass Kg
BS 4504	6/3	160.0	16.0	110.0	3.0	4	14.0	M12	130.0	1.6
	10/3	185.0	18.0	122.0	3.0	4	18.0	M16	145.0	2.7
	16/3	185.0	18.0	122.0	3.0	4	18.0	M16	145.0	2.7
	25/3	185.0	22.0	122.0	3.0	8	18.0	M16	145.0	3.2
	40/3	185.0	22.0	122.0	3.0	8	18.0	M16	145.0	3.2
SABS 1123	600/3	160.0	10.0	110.0	3.0	4	14.0	M12	130.0	1.0
	1000/3	185.0	12.0	122.0	3.0	4	18.0	M16	145.0	1.8
	1600/3	185.0	12.0	122.0	3.0	4	18.0	M16	145.0	1.8
	2500/3	185.0	22.0	122.0	3.0	8	18.0	M16	145.0	3.2
	4000/3	185.0	22.0	122.0	3.0	8	18.0	M16	145.0	3.2
BS 10	D	165.1	7.9			4	17.5	15.9	127.0	1.7
	E	165.1	10.3			4	17.5	15.9	127.0	1.7
	F	184.1	15.9			8	17.5	15.9	146.0	2.7
ASME B16.5	150	177.8	22.2	104.8	1.6	4	19.0	5/8"	139.7	3.3
	300	190.5	25.4	104.8	1.6	8	22.2	3/4"	149.2	4.4
	600	190.5	34.9	104.8	6.4	8	22.2	3/4"	149.2	

32 mm Nominal Bore (1 1/4") - Pipe OD 42.4mm

Standard	Class/ Table	Flange OD	Flange Thickness (B)	Raised Face Dia. (d3)	Raised Face Height	No. Holes	Hole Dia (d1)	Bolt Size	PCD	Mass Kg
BS 4504	6/3	120.0	16.0	70.0	2.0	4	14.0	M12	90.0	1.1
	10/3	140.0	16.0	78.0	2.0	4	18.0	M16	100.0	1.5
	16/3	140.0	16.0	78.0	2.0	4	18.0	M16	100.0	1.5
	25/3	140.0	18.0	78.0	2.0	4	18.0	M16	100.0	1.7
	40/3	140.0	18.0	78.0	2.0	4	18.0	M16	100.0	1.7



**ENERGY
METALS**

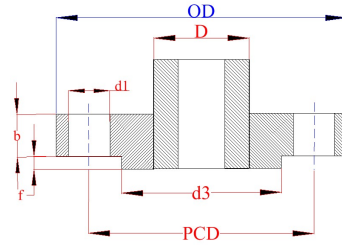

ENERGY
ENGINEERED PRODUCTS

DISTRIBUTORS OF INDUSTRIAL STAINLESS STEEL PRODUCTS: PIPE, FITTINGS, FLANGES, ROUND BAR, VALVES

FLANGE TABLES

100 mm Nominal Bore (4") - Pipe OD 114.3mm

Standard	Class/ Table	Flange OD	Flange Thickness (B)	Raised Face Dia. (d3)	Raised Face Height	No. Holes	Hole Dia (d1)	Bolt Size	PCD	Mass Kg
BS 4504	6/3	210.0	18.0	148.0	3.0	4	18.0	M16	170.0	2.9
	10/3	220.0	20.0	158.0	3.0	8	18.0	M16	180.0	3.6
	16/3	220.0	20.0	158.0	3.0	8	18.0	M16	180.0	3.6
	25/3	235.0	26.0	162.0	3.0	8	22.0	M20	190.0	5.7
	40/3	235.0	26.0	162.0	3.0	8	22.0	M20	190.0	5.7
SABS 1123	600/3	210.0	10.0	148.0	3.0	4	18.0	M16	170.0	1.6
	1000/3	220.0	12.0	158.0	3.0	8	18.0	M16	180.0	2.2
	1600/3	220.0	14.0	158.0	3.0	8	18.0	M16	180.0	2.5
	2500/3	235.0	25.0	162.0	3.0	8	22.0	M20	190.0	5.5
	4000/3	235.0	25.0	162.0	3.0	8	22.0	M20	190.0	5.5
BS 10	D	215.9	9.5			4	17.5	15.9		2.3
	E	215.9	13.7			8	17.5	15.9		2.3
	F	228.6	19.0			8	17.5	15.9		4.5
ASME B16.5	150	228.6	23.8	157.2	1.6	8	19.0	5/8"	190.5	5.3
	300	254.0	31.8	157.2	1.6	8	22.2	3/4"	200.0	9.6
	600	273.1	44.4	157.2	6.4	8	25.4	7/8"	215.9	

250 mm Nominal Bore (10") - Pipe OD 273mm

Standard	Class/ Table	Flange OD	Flange Thickness (B)	Raised Face Dia. (d3)	Raised Face Height	No. Holes	Hole Dia (d1)	Bolt Size	PCD	Mass Kg
BS 4504	6/3	375.0	24.0	312.0	3.0	12	18.0	M16	335.0	8.5
	10/3	395.0	26.0	320.0	3.0	12	22.0	M20	350.0	11.0
	16/3	405.0	26.0	320.0	3.0	12	26.0	M24	355.0	12.0
	25/3	425.0	32.0	335.0	3.0	12	30.0	M27	370.0	17.0
	40/3	450.0	42.0	345.0	3.0	12	33.0	M30	385.0	28.5
SABS 1123	600/3	375.0	16.0	312.0	3.0	12	18.0	M16	335.0	5.7
	1000/3	395.0	20.0	320.0	3.0	12	22.0	M20	350.0	8.5
	1600/3	405.0	25.0	320.0	3.0	12	26.0	M24	355.0	11.5
	2500/3	425.0	30.0	335.0	3.0	12	26.0	M24	370.0	16.4
	4000/3	450.0	38.0	345.0	3.0	12	33.0	M30	385.0	25.8
BS 10	D	406.4	15.9			8	22.2	19		355.6
	E	406.4	22.2			12	22.2	19		355.6
	F	431.8	28.6			12	25.4	22.2		381.0
ASME B16.5	150	406.4	30.2	323.8	1.6	12	25.4	7/8"	361.9	16.5
	300	444.5	47.6	323.8	1.6	16	28.6	1"	387.3	37.1
	600	508.0	69.8	323.8	6.4	16	34.9	1 1/4"	431.8	

125 mm Nominal Bore (5") - Pipe OD 139.7mm

Standard	Class/ Table	Flange OD	Flange Thickness (B)	Raised Face Dia. (d3)	Raised Face Height	No. Holes	Hole Dia (d1)	Bolt Size	PCD	Mass Kg
BS 4504	6/3	240.0	20.0	178.0	3.0	8	18.0	M16	200.0	3.9
	10/3	250.0	22.0	188.0	3.0	8	18.0	M16	210.0	5.0
	16/3	250.0	22.0	188.0	3.0	8	18.0	M16	210.0	5.0
	25/3	270.0	28.0	188.0	3.0	8	26.0	M24	220.0	7.7
	40/3	270.0	28.0	188.0	3.0	8	26.0	M24	220.0	7.7
SABS 1123	600/3	240.0	12.0	178.0	3.0	8	18.0	M16	200.0	2.3
	1000/3	250.0	14.0	188.0	3.0	8	18.0	M16	210.0	3.2
	1600/3	250.0	16.0	188.0	3.0	8	18.0	M16	210.0	3.6
	2500/3	270.0	28.0	188.0	3.0	8	26.0	M24	220.0	7.7
	4000/3	270.0	28.0	188.0	3.0	8	26.0	M24	220.0	7.7
BS 10	D	254.0	12.7			8	17.5	15.9	209.6	3.5
	E	254.0	14.3			8	17.5	15.9	209.6	3.8
	F	279.4	22.2			8	22.2	19	234.9	7.8
ASME B16.5	150	254.0	23.8	185.7	1.6	8	22.2	3/4"	215.9	6.0
	300	279.4	34.9	185.7	1.6	8	22.2	3/4"	235.0	12.3
	600	330.2	50.7	185.7	6.4	8	28.6	1"	266.7	

300 mm Nominal Bore (12") - Pipe OD 323.9mm

Standard	Class/ Table	Flange OD	Flange Thickness (B)	Raised Face Dia. (d3)	Raised Face Height	No. Holes	Hole Dia (d1)	Bolt Size	PCD	Mass Kg
BS 4504	6/3	440.0	24.0	365.0	4.0	12	22.0	M20	395.0	11.0
	10/3	445.0	26.0	370.0	4.0	12	22.0	M20	400.0	12.5
	16/3	460.0	28.0	378.0	4.0	12	26.0	M24	410.0	15.5
	25/3	485.0	38.0	395.0	4.0	16	30.0	M27	430.0	25.5
	40/3	515.0	50.0	410.0	4.0	16	33.0	M30	450.0	42.0
SABS 1123	600/3	440.0	20.0	365.0	4.0	12	22.0	M20	395.0	9.2
	1000/3	445.0	22.0	370.0	4.0	12	22.0	M20	400.0	10.6
	1600/3	460.0	28.0	378.0	4.0	12	26.0	M24	410.0	15.5
	2500/3	485.0	32.0	395.0	4.0	16	26.0	M24	430.0	21.5
	4000/3	515.0	40.0	410.0	4.0	16	33.0	M30	450.0	33.6
BS 10	D	457.2	19.0			12	22.2	19		406.4
	E	457.2	25.4			12	25.4	22.2		406.4
	F	489.0	31.8			16	25.4	22.2		438.2
ASME B16.5	150	482.6	31.8	381.0	1.6	12	25.4	7/8"	431.8	26.2
	300	520.7	50.8	382.0	1.6	16	31.7	1 1/8"	450.8	50.0
	600	558.8	73.0	381.0	6.4	20	34.9	1 1/4"	488.9	

150 mm Nominal Bore (6") - Pipe OD 168.3mm

Standard	Class/ Table	Flange OD	Flange Thickness (B)	Raised Face Dia. (d3)	Raised Face Height	No. Holes	Hole Dia (d1)	Bolt Size	PCD	Mass Kg
BS 4504	6/3	265.0	20.0	202.0	3.0	8	18.0	M16	225.0	4.4
	10/3	285.0	22.0	212.0	3.0	8	22.0	M20	240.0	6.0
	16/3	285.0	22.0	212.0	3.0	8	22.0	M20	240.0	6.0
	25/3	300.0	30.0	218.0	3.0	8	26.0	M24	250.0	9.7
	40/3	300.0	30.0	218.0	3.0	8	26.0	M24	250.0	9.7
SABS 1123	600/3	265.0	12.0	202.0	3.0	8	18.0	M16	225.0	2.6
	1000/3	285.0	16.0	212.0	3.0	8	22.0	M20	240.0	4.4
	1600/3	285.0	18.0	212.0	3.0	8	22.0	M20	240.0	4.9
	2500/3	300.0	30.0	218.0	3.0	8	26.0	M24	250.0	9.7
	4000/3	300.0	30.0	218.0	3.0	8	26.0	M24	250.0	9.7
BS 10	D	279.4	12.7			8	17.5	15.9	235.0	3.9
	E	279.4	17.5			8	22.2	19	235.0	5.4
	F	304.8	22.2			12	22.2	19	260.4	8.7
ASME B16.5	150	279.4	25.4	215.9	1.6	8	22.2	3/4"	241.3	7.4
	300	317.5	36.5	215.9	1.6	12	22.2	3/4"	269.9	15.6
	600	355.6	53.9	215.9	6.4	12	28.6	1"	292.1	

350 mm Nominal Bore (14") - Pipe OD 355.6mm

Standard	Class/ Table	Flange OD	Flange Thickness (B)	Raised Face Dia. (d3)	Raised Face Height	No. Holes	Hole Dia (d1)	Bolt Size	PCD	Mass Kg
BS 4504	6/3	490.0	26.0	415.0	4.0	12	22.0	M20	445.0	15.5
	10/3	505.0	28.0	430.0	4.0	16	22.0	M20	460.0	19.5
	16/3	520.0	32.0	438.0	4.0	16	26.0	M24	470.0	24.5
	25/3	555.0	42.0	450.0	4.0	16	33.0	M30	490.0	40.5
	40/3	580.0	56.0	465.0	4.0	16	36.0	M33	510.0	63.0
SABS 1123	600/3	490.0	22.0	415.0	4.0	12	22.0	M20	445.0	13.1
	1000/3	505.0	25.0	430.0	4.0	16	22.0	M20	460.0	17.4
	1600/3	520.0	30.0	438.0	4.0	16	26.0	M24	470.0	23.0
	2500/3	555.0	35.0	450.0	4.0	16	33.0	M30	490.0	33.8
	4000/3	580.0	45.0	465.0	4.0	16	33.0	M30	510.0	50.6
BS 10	D	527.1	22.2			12	25.4	22.2		469.9
	E	527.1	28.6			12	25.4	22.2		469.9
	F	552.5	34.9			16	28.6	25.4		495.3
ASME B16.5	150	533.4	34.9	412.7	1.6	12	28.6	1"	476.2	36.0
	300	584.2	54.0	412.7	1.6	20	31.7	1 1/8"	514.3	
	600	603.2	76.2	412.0	6.4	20	38.1	?	527.0	

200 mm Nominal Bore (8") - Pipe OD 219.1mm

Standard	Class/ Table	Flange OD	Flange Thickness (B)	Raised Face Dia. (d3)	Raised Face Height	No. Holes	Hole Dia (d1)	Bolt Size	PCD	Mass Kg
BS 4504	6/3	320.0	22.0	258.0	3.0	8	18.0	M16	280.0	6.4
	10/3	340.0	24.0	268.0	3.0	8	22.0	M20	295.0	8.7
	16/3	340.0	24.0	268.0	3.0	12	22.0	M20	295.0	8.4
	25/3	360.0	28.0	278.0						



**ENERGY
METALS**

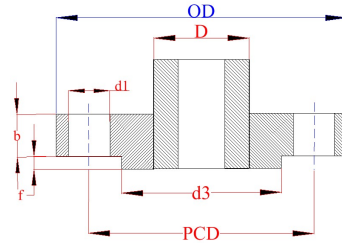

ENERGY
ENGINEERED PRODUCTS

DISTRIBUTORS OF INDUSTRIAL STAINLESS STEEL PRODUCTS: PIPE, FITTINGS, FLANGES, ROUND BAR, VALVES

FLANGE TABLES

450 mm Nominal Bore (18") - Pipe OD 457.2mm

Standard	Class/ Table	Flange OD	Flange Thickness (B)	Raised Face Dia. (d3)	Raised Face Height	No. Holes	Hole Dia (d1)	Bolt Size	PCD	Mass Kg
BS 4504	6/3	595.0	30.0	520.0	4.0	16	22.0	M20	550.0	
	10/3	615.0	36.0	532.0	4.0	20	26.0	M24	565.0	
	16/3	640.0	40.0	550.0	4.0	20	30.0	M27	585.0	
	25/3	670.0	52.0	555.0	4.0	20	36.0	M33	600.0	
	40/3	685.0	68.0	560.0	4.0	20	39.0	M36	610.0	
SABS 1123	600/3	595.0	25.0	520.0	4.0	16	22.0	M20	550.0	
	1000/3	615.0	30.0	532.0	4.0	20	26.0	M24	565.0	
	1600/3	640.0	40.0	550.0	4.0	20	36.0	M24	585.0	
	2500/3	670.0	45.0	555.0	4.0	20	33.0	M30	600.0	
	4000/3	685.0	60.0	575.0	4.0	20	39.0	M36	610.0	
BS 10	D	641.4	25.4			12	25.4	22.2	584.2	30.8
	E	641.4	34.9			16	25.4	22.2	584.2	42.9
	F	673.1	44.5			20	31.8	28.6	609.9	64.7
ASME B16.5	150	635.0	39.7	533.4	1.6	16	31.7	1 1/8"	577.8	49.0
	300	711.2	60.3	533.4	1.6	24	34.9	1 1/4"	628.6	
	600	742.9	88.9	533.4	6.4	20	44.4	1 5/8"	654.0	

800 mm Nominal Bore (32") - Pipe OD 812.8mm

Standard	Class/ Table	Flange OD	Flange Thickness (B)	Raised Face Dia. (d3)	Raised Face Height	No. Holes	Hole Dia (d1)	Bolt Size	PCD	Mass Kg
BS 4504	6/3	975.0	38.0	880.0	5.0	24	30.0	M27	920.0	58.0
	10/3	1015.0	52.0	905.0	5.0	24	33.0	M30	950.0	105.0
	16/3	1025.0	64.0	900.0	5.0	24	39.0	M36	950.0	135.0
	25/3									
	40/3									
SABS 1123	600/3	975.0	38.0	880.0	5.0	24	26.0	M24	920.0	58.0
	1000/3	1015.0	50.0	905.0	5.0	24	33.0	M30	950.0	101.0
	1600/3	1025.0	65.0	900.0	5.0	24	39.0	M36	950.0	137.1
	2500/3									
	4000/3									
BS 10	D	997.0				20	33.0	M30	927.0	
	E	997.0				20	33.0	M30	927.0	
	F									
ASME B16.5	150	1060.4	80.9	914.4	1.6	28	41.3	1 1/2"	977.9	
	300	149.3	98.4	914.4	1.6	28	50.8	1 7/8"	1054.1	
	600	1193.8	123.8	914.4	6.4	28	60.3		1079.5	

500 mm Nominal Bore (20") - Pipe OD 508mm

Standard	Class/ Table	Flange OD	Flange Thickness (B)	Raised Face Dia. (d3)	Raised Face Height	No. Holes	Hole Dia (d1)	Bolt Size	PCD	Mass Kg
BS 4504	6/3	645.0	30.0	570.0	4.0	20	22.0	M20	600.0	25.5
	10/3	670.0	38.0	585.0	4.0	20	26.0	M24	620.0	39.0
	16/3	715.0	44.0	610.0	4.0	20	30.0	M30	650.0	60.0
	25/3	730.0	58.0	615.0	4.0	20	36.0	M33	660.0	86.0
	40/3	755.0	72.0	615.0	4.0	20	42.0	M39	670.0	120.0
SABS 1123	600/3	645.0	25.0	570.0	4.0	20	22.0	M20	600.0	21.3
	1000/3	670.0	32.0	585.0	4.0	20	26.0	M24	620.0	32.8
	1600/3	715.0	40.0	610.0	4.0	20	30.0	M30	650.0	54.6
	2500/3	730.0	50.0	615.0	4.0	20	33.0	M30	660.0	74.1
	4000/3	755.0	70.0	615.0	4.0	20	39.0	M36	670.0	116.7
BS 10	D	704.9	28.6			16	25.4	22.2	641.4	41.1
	E	704.9	38.1			16	25.4	22.2	641.4	55.8
	F	736.6	50.8			24	31.7	28.6	673.1	87.1
ASME B16.5	150	698.5	42.9	584.2	1.6	20	31.7	1 1/8"	635.0	61.9
	300	774.7	63.5	584.2	1.6	24	34.9	1 1/4"	685.8	
	600	812.8	95.2	584.2	6.4	24	44.4	1 5/8"	723.9	

900 mm Nominal Bore (36") - Pipe OD 914.4mm

Standard	Class/ Table	Flange OD	Flange Thickness (B)	Raised Face Dia. (d3)	Raised Face Height	No. Holes	Hole Dia (d1)	Bolt Size	PCD	Mass Kg
BS 4504	6/3	1075.0	42.0	980.0	5.0	24	30.0	M27	1020.0	72.0
	10/3	1115.0	56.0	1005.0	5.0	28	33.0	M30	1050.0	125.0
	16/3	1125.0	72.0	1000.0	5.0	28	39.0	M36	1050.0	165.0
	25/3									
	40/3									
SABS 1123	600/3	1075.0	40.0	980.0	5.0	24	26.0	M24	1020.0	68.6
	1000/3	1115.0	55.0	1005.0	5.0	28	33.0	M30	1050.0	122.8
	1600/3	1125.0	70.0	1000.0	5.0	28	39.0	M36	1050.0	160.4
	2500/3									
	4000/3									
BS 10	D	1174.7	47.6			24	35.0	31.8	1092.2	156.3
	E	1174.7	63.5			24	35.0	31.8	1092.2	203.1
	F									
ASME B16.5	150	168.4	90.5	1022.3	1.6	32	41.3	1 1/2"	1085.8	
	300	1270.0	104.8	1022.3	1.6	32	54.0	2"	1168.4	
	600	1314.4	130.4	1022.3	6.4	28	60.3		1162.0	

600 mm Nominal Bore (24") - Pipe OD 609.6mm

Standard	Class/ Table	Flange OD	Flange Thickness (B)	Raised Face Dia. (d3)	Raised Face Height	No. Holes	Hole Dia (d1)	Bolt Size	PCD	Mass Kg
BS 4504	6/3	755.0	32.0	670.0	5.0	20	26.0	M24	705.0	33.0
	10/3	780.0	42.0	685.0	5.0	20	30.0	M27	725.0	53.0
	16/3	840.0	52.0	725.0	5.0	20	36.0	M33	770.0	94.0
	25/3	845.0	66.0	720.0	5.0	20	39.0	M36	770.0	120.0
	40/3									
SABS 1123	600/3	755.0	30.0	670.0	5.0	20	M24	M24	705.0	30.9
	1000/3	780.0	38.0	685.0	5.0	20	M24	M24	725.0	48.0
	1600/3	840.0	50.0	725.0	5.0	20	M30	M30	770.0	90.4
	2500/3	845.0	60.0	720.0	5.0	20	M36	M36	770.0	109.1
	4000/3									
BS 10	D	825.5	31.8			16	25.4	25.4	755.7	60.3
	E	825.5	47.6			16	28.6	28.6	755.7	89.3
	F	850.9	57.2			24	31.8	31.8	781.1	122.8
ASME B16.5	150	812.8	47.6	692.1	1.6	20	34.9	1 1/4"	749.3	86.9
	300	914.4	69.8	692.1	1.6	24	41.3	1 1/2"	812.8	
	600	939.8	107.9	692.1	6.4	24	50.8	1 7/8"	838.2	

1000 mm Nominal Bore (40") - Pipe OD 1016mm

Standard	Class/ Table	Flange OD	Flange Thickness (B)	Raised Face Dia. (d3)	Raised Face Height	No. Holes	Hole Dia (d1)	Bolt Size	PCD	Mass Kg
BS 4504	6/3	1175.0	46.0	1080.0	5.0	28	30.0	M27	1120.0	86.0
	10/3	1230.0	62.0	1110.0	5.0	28	36.0	M33	1160.0	160.0
	16/3	1255.0	78.0	1115.0	5.0	28	42.0	M39	1170.0	230.0
	25/3									
	40/3									
SABS 1123	600/3	1175.0	45.0	1080.0	5.0	28	26.0	M24	1120.0	84.1
	1000/3	1230.0	60.0	1110.0	5.0	28	33.0	M30	1160.0	154.8
	1600/3	1255.0	75.0	1115.0	5.0	28	39.0	M36	1170.0	221.2
	2500/3									
	4000/3									
BS 10	D	1257.3	50.8			24	35.0	31.8	1174.7	167.0
	E	1257.3	66.7			24	38.1	34.9	1174.7	214.0
	F									
ASME B16.5	150	1289.1	90.5	1123.9	1.6	36	41.3	1 1/2"	1200.1	
	300	1238.3	114.3	1085.8	1.6	32	44.4	1 5/8"	1155.7	
	600	1320.8	165.2	1111.2	6.4	32	60.3		1212.8	

700 mm Nominal Bore (28") - Pipe OD 711.2mm

Standard	Class/ Table	Flange OD	Flange Thickness (B)	Raised Face Dia. (d3)	Raised Face Height	No. Holes	Hole Dia (d1)	Bolt Size	PCD	Mass Kg
BS 4504	6/3	860.0	34.0	775.0	5.0	24	26.0	M24	810.0	42.0
	10/3	895.0	46.0	800.0	5.0	24	30.0	M27	840.0	73.0
	16/3	910.0	58.0	795.0	5.0	24	36.0	M33	840.0	99.0
	25/3									
	40/3									
SABS 1123	600/3	860.0	35.0	775.0	5.0	24	26.0	M24	810.0	43.3
	1000/3	895.0	45.0	800.0	5.0	24	26.0	M24	840.0	71.4
	1600/3	910.0	55.0	795.0	5.0	24	33.0	M30	840.0	93.9
	2500/3									
	4000/3									